

# Wisconsin Family Child Care Association presents



38th Annual Conference

May 2, 3, 4, 2019

Chula Vista, Wisconsin Dells

[www.wisconsinfamilychildcare.org](http://www.wisconsinfamilychildcare.org)

# 2019 Conference Fees

	<u>Member</u>	<u>Non-Member*</u>
<b>1 Day: Thursday</b> After March 15	<b>\$70.00</b> \$90.00	<b>\$100.00</b> \$120.00
<b>1 Day: Friday or Saturday</b> After March 15	<b>\$75.00</b> \$95.00	<b>\$105.00</b> \$125.00
<b>2 Days: Thursday &amp; Friday</b> After March 15	<b>\$145.00</b> \$165.00	<b>\$175.00</b> \$195.00
<b>2 Days: Friday &amp; Saturday</b> After March 15	<b>\$130.00</b> \$150.00	<b>\$160.00</b> \$180.00
<b>3 Days: Thursday - Saturday</b> After March 15	<b>\$185.00</b> \$205.00	<b>\$215.00</b> \$235.00

\* This year all non-member registrations include a FREE one-year membership in WFCCA, valued at \$20!

## Hotel Accommodations



### Chula Vista Resort

2501 River Road Wisconsin Dells, WI 53965  
Reserve by March 31st  
(888) 974-0563  
Call in to use code **F27265**

### Tower Guest Room - \$99.00/night

Our tower guest rooms are ideal for families, couples or business travelers who need either two queen-size beds or one king-size bed with a sofa sleeper.

Offering a relaxing and cozy stay, the tower guest rooms offer easy access to a variety of Chula Vista amenities, including dining, water parks, gift shops, and more!

Check-In 4:00 pm - Check Out 10:30 am



# Help Wanted

It is an exciting time to become a member of the WFCCA Board of Directors! We are currently looking for Regional representatives for the upcoming 2 year terms. WFCCA will be voting in Representatives from Regions 1,2,3,4,5, and 7 at the May Conference.

Regional Representatives shall:

1. Represent their region when voting is required.
2. Serve as a channel through which essential information from the Association will reach early child care professionals.
3. Bring to the Association official announcements and directives from their region.
4. Bring to the Association any significant information on child care issues in their region.

Duties of Representatives:

- Attend board meetings
- Maintain current Wisconsin Family Child Care Association membership
- Serve on committees
- Attend the annual caucus and help at the annual May conference
- Be the contact for early child care professionals in their region
- Be open to helping with a mini conference in your region
- Work with the other two elected Region Reps in your region

Benefits of Representatives:

- Reduced conference fees
- Support and networking amongst colleagues
- Professional recognition
- Advocacy opportunities
- Friendships and positive relationships with others on the board
- Opportunities to learn more within the Early Childhood field
- Opportunities to do trainings for others

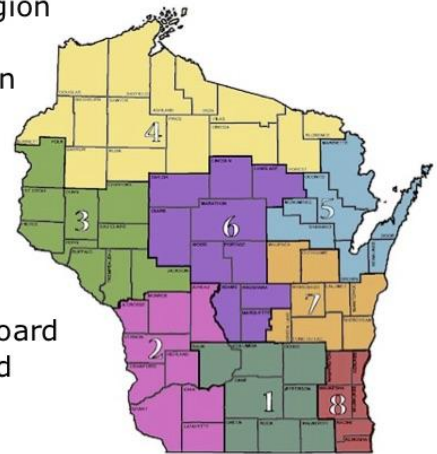

Sound interesting? Have more questions? Feel free to email [wisfcca@gmail.com](mailto:wisfcca@gmail.com) or call 608-322-1260 to speak to a board member. Want a position? Send in a bio (nothing fancy, just a few sentences about you and your connection to Family Child Care) to [wisfcca@gmail.com](mailto:wisfcca@gmail.com) and we will add you to the voting ballot at the conference, even if you are not able to be there in person.

# NO SMALL MATTER

Join us for this free public event

at the Chula Vista

Rooms G,H,I combined

May 3 from 6:30-8:30

No Small Matter is built from stories of real children, families, and teachers, illustrating the impact of high quality early childhood experiences. We meet parents who are struggling to do their best for their kids, incredible teachers who model what early childhood classrooms should and could be like, and children learning and developing in real time. Change is necessary, critical, and attainable if we put our minds to it. There is also interesting, easy to understand scientific discussion and graphics of how the human brain works. Furthermore, how we can use that information to create developmentally appropriate environments for children to learn and grow to their fullest potential.

To watch a trailer go to [Nosmallmatter.com](http://Nosmallmatter.com)

The video is 75 minutes long and will be followed by a discussion of the documentary and what we can do to invest in early childhood education

If on Facebook go to No Small Matter and find the May 3rd screening at the Chula Vista in Wisconsin Dells for more information and to RSVP or tell your early childhood educator.

Sponsored by: **weca** Wisconsin Early  
Childhood Association

# Welcome

Welcome to the 2019 WFCCA Conference!  
Thank you for taking time out of your busy lives to attend our conference. We're so glad that you are here!

## About WFCCA

The Wisconsin Family Child Care Association (WFCCA) is a statewide organization of Family Child Care providers and their supporters, formed to provide support, involvement, and communication with others in the profession.

## Network Tangram

Complete your tangram by trading pieces with attendees who have different shapes than you do. When complete, turn in at the Registration Table for a chance to win a 2020 Conference Package.

# Contents

- 1 Welcome & About WFCCA
- 1 Networking Tangram
- 2 President's Letter
- 2 Conference Sponsors
- 3 Important Information
- 4 Special Events & Activities
- 4 2019 Caucus & Exhibitors
- 5 Conference Meals
- 5 Continuing Education Hours
- 6 Keynote Presentations
- 7 Thursday Workshops
- 12 Friday Workshops
- 12 Saturday Workshops
- 14 Certificate of Participation
- 15 Workshop Schedule

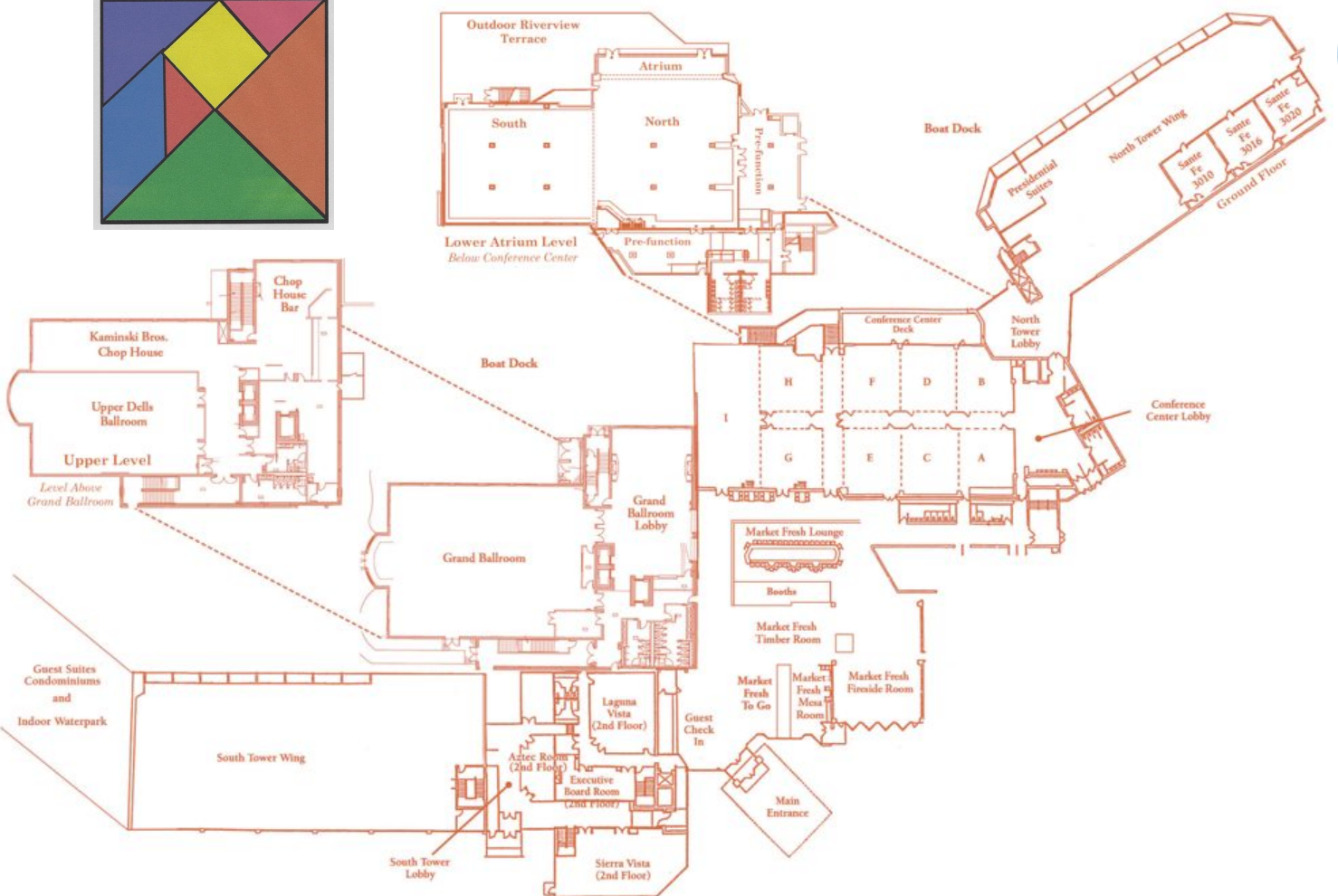
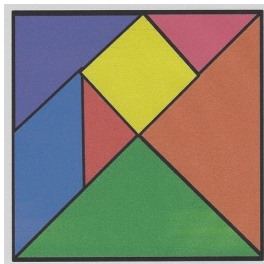

# A Letter from Our President

Hello Conference Attendees,

Welcome to the Wisconsin Family Child Care Association's 38th Annual Conference at the Chula Vista Wisconsin Dells, WI. I'm so happy that you have chosen to attend our conference.

We are offering some wonderful educational and networking opportunities for all child care professionals. Our theme this year is "Dream, Inspire, Grow." As family child care providers, we have the opportunity to spark the imagination for our little ones every day. I want to challenge you as a provider to think about what dreams you have for your business and grow into that direction to keep you inspired as well. Use the time with your colleagues this weekend to bounce ideas off each other and learn from the classes to help make the process possible. Talk to the resource booths to get some great information to move your career to a new level. Shop the exhibitors to get some great resources. The possibilities are endless for you to reach for your dreams!

Our Board Members have put many volunteer hours into organizing and preparing for our conference to make it the best possible experience for you. We listen to your requests, so I encourage you to talk to myself and members of the board, as well as filling out the evaluation form to turn it in. If you want a certain workshop, presenter or keynote to return, or even if you have suggestions to make it an experience that participants will remember, please share them with us. If you see anyone that is wearing a blue lanyard with the WFCCA logo on it, they are Board Members who can help with any questions you may have.

I ask you....have you considered getting more involved in the Wisconsin Family Child Care Association? We are voting in Region Reps for odd regions, and have some spots available for the even ones too. It is a rewarding experience to be part of a greater good. I have built some great friendships along my journey as a board member, and have been able to help some great providers as well. There is nothing difficult about being a board member, we will support you to learn and grow with us to learn the ropes. If you have the time, and the passion in the child care profession, please join us as a board member!

If you see me at the conference, please stop by and say hello. I am very interested in what you have to say. Thank you for your continued support of Wisconsin Family Child Care Association.

Warmest Regards,

Leah Zastoupil, WFCCA President

## Conference Sponsors

**Gold Level** \* Mother Goose Time Early Learning Curriculum \* The Payroll Company \*

**Silver Level** \* Child Care Resource & Referral \* HEART Family Child Care Support Group \*

**Bronze Level** \* FunShine Express \* Horizons Food Program \* Kaplan Early Learning Company \*  
\* Redleaf Press \*

**Supporter Level** \* Fox Communities Credit Union \* Gee Whiz Education \* Supporting Families Together Association \* Tiffany Holtz - Coldwell Bankers \* Wisconsin Early Childhood Association \*

**Friends Level** \* Edward Jones Investments \* Kobussen Buses Ltd. \* Reynolds Auctions \* Rob Seeman Agency \*

And others who gave at individual levels. Thanks to you all - we couldn't do it without you!

# Important Information

## **WFCCA Table**

Get involved in your professional association! Stop by the WFCCA table to learn about member benefits, events in your area, and meet WFCCA representatives. Ask questions or just chat a bit; we'd love to get to know you! Board members are wearing blue name tags so you can easily identify us.

## **Children at the Conference**

While we all love children, most conference participants look forward to spending this time with other adults. Children are not allowed in keynote presentations or breakout workshops, with the exception of nursing infants.

## **Evaluations**

We want your feedback! Please complete evaluations for individual workshops as well as one for the entire conference. Your input is very valuable in helping us continue to improve the conference.

## **Exhibits**

The exhibits are open Friday, 7:00am - 5:00pm and Saturday, 7:00am - 3:00pm. Stop in, browse, buy, and pick up resource information for your child care business.

## **Facilities**

The facilities of the hotel are available to all conference participants. WFCCA can not be held responsible for inconveniences caused by the Chula Vista. We cannot control room temperatures, so please dress in layers so you can adjust accordingly.

## **Hospitality Room - Room 3101**

The Hospitality room is open Friday 7:00am - 5:00pm and Saturday, 7:00am - 3:00pm. Roundtable sessions will be held in the Hospitality Room 11:00am - 12:15pm on Friday and Saturday.

## **Lost and Found**

Please check the hotel front desk or the conference Registration Table. WFCCA cannot

be held responsible for lost or stolen items.

## **Message Board**

Please check the message board by the conference Registration Table for updates throughout the conference. While we make every effort to minimize program changes, they are unavoidable, and we appreciate your understanding.

## **Name Tags**

Name tags **MUST** be worn for admittance to ALL conference events.

## **Photo/Video Disclaimer**

By registering for the WFCCA conference you are agreeing that WFCCA may take photos, videos and/or audio recordings of you during the conference and use these materials, with or without your name, for any lawful purpose, including but not restricted to our website, Facebook page and newsletter.

## **Registry Credit**

Continuing education credit is given for all workshops, keynotes, the Scavenger Hunt, Blackout Bingo, and Saturday's luncheon meeting. Attendance stickers will be distributed at the end of each session. If workshops have two parts you must attend both parts to get Registry credit. Stickers can be placed on your Certificate of Participation at the end of this book for safekeeping.

## **Workshops**

Workshops are listed in the conference book. Pre-registration is not required. To attend a workshop, simply go to the appropriate room at the proper time. Attendance is first-come-first-served, so we recommend that you arrive at least 10 minutes early. Since every room has a maximum capacity, if a session becomes full the workshop host will help you to find another workshop.

## Special Events and Activities

### **New Attendee Orientation - Registration Area**

Friday and Saturday, 7:00am - 7:30am

Tips and tricks to get the most out of your conference experience.

### **Annual Meeting - Grand Ballroom**

Friday Luncheon

Keep up-to-date with WFCCA and connect with your regional representative afterward.

### **No Small Matter - Rooms G, H & I**

Friday 6:30-8:30pm

Stories of real children, families, teachers, and high quality early childhood experiences.

### **Blackout Bingo - Exhibitor Area**

Friday & Saturday

Complete your Blackout Bingo card and bring to the Registration Table for 1 hour of continuing education.

### **Scavenger Hunt - Conference Area**

Friday & Saturday

Look for clues and turn in your answers at the Registration Table to earn 1 hour of continuing education.

### **Provider of the Year Award - Grand Ballroom**

Saturday Luncheon

This is the highest honor for Wisconsin family child care providers. Help us congratulate and celebrate this year's recipient!!

### **History of WFCCA - Grand Ballroom**

Saturday Luncheon

Learn about WFCCA and how we advocate for you. Caucuses will be held in Regions 1, 3, 5, 7.



# Horizons

A Sponsor of the

**Child and Adult Care Food Program**

This Institution is an Equal Opportunity Provider

## Exhibitors

- \* Tammy's Tupperware \*
- \* LuLaRoe Christina Gabrus \*
- \* Supporting Children & Families \*
- \* UW Milwaukee \* UW Whitewater \*
- \* Fabulous Felts \* WECA Food Program \*
- \* Growth Chart Records \* Honey Do Toys \*
- \* Baby Signs 4 You \* Read to Me Resale \*
- \* Color Street \* Constructive Playthings \*
- \* The Registry \* Princess P Designs \*
- \* Nelly and Jack Enterprises LLC \*
- \* CJ Puzzles \* Spilt Milk Print Co \*
- \* Mother Goose Curriculum \*

**KAPLAN**<sup>®</sup>  
EARLY LEARNING COMPANY

1-800-334-2014 • [www.kaplanco.com](http://www.kaplanco.com)

For more information:

**Pam Tester**

Territory Manager

800-334-2014, ext. 6122

[ptester@kaplanco.com](mailto:ptester@kaplanco.com)



## Conference Meals

Lunch is included for registrations postmarked before **April 20th**. Lunch tickets are in your name tag holder and are required for lunch.

### Thursday Lunch

#### Soup and Sandwich Bar - Room D/F

Sliced turkey and ham, tuna salad, assorted cheeses, lettuce, tomato, onions, breads, rolls, pickles, tomato bisque soup, and creamy chicken rice soup. Served with coffee, tea, and milk.

### Friday Lunch

#### Soup and Salad Bar - Grand Ballroom

Crisp garden greens, fresh fruits, shredded cheeses, chilled hard eggs, fresh vegetables, ham, turkey, tailgate chili, and cheesy broccoli soup. Served with fresh salads, cottage cheese, dressings, toppings, artisan rolls and bread. Served with coffee, tea, and milk.

### Saturday Lunch

#### Italian Pasta Buffet - Grand Ballroom

Three cheese ravioli, penne pasta carbonara, marinara and alfredo sauce. Served with grilled antipasto and olive bar, fresh Italian rolls and breads, shredded Parmesan and Romano cheeses. Includes Caesar salad, tomato and bread panzenella, marble cake, coffee, tea, and milk.

\*Unfortunately we are not able to accommodate special meal requests.



# Redleaf Press®

**Trusted Resources in Early Learning**

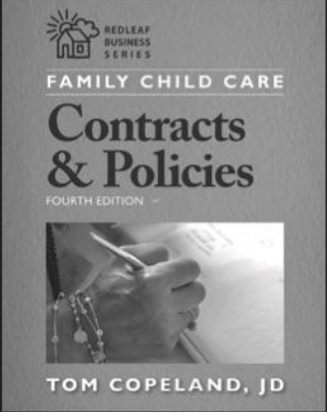

ISBN: 978-1-60554-650-6 • \$19.95



ISBN: 978-1-60554-548-6 • \$19.95



ISBN: 978-0-473-43317-8 • \$17.95

[www.RedleafPress.org](http://www.RedleafPress.org)

## Continuing Education Hours

**Thursday** AM & PM: 6 hours

**Friday** Keynote, AM & PM: 6.25 hours

No Small Matter: 2 hours

**Saturday** Keynote & AM: 3.75 hours

Lunch: 1 hour, Closing Keynote: 1.25 hours

**Additional** (earn once)

Exhibitor Bingo: 1 hour

Scavenger Hunt: 1 hour



# FunShine

## Express®

Early Learning Curricula

# Keynote Presentations

## Dan Hodgins

### Getting them Outside

Friday 8:00am - Room I

The importance of outdoor play is discussed with experiences that support natural play.



Daniel J Hodgins is an exceptional, internationally renowned presenter and author of two books titled, *Boys: Changing the Classroom, Not the Child* and his new book titled, *GET OVER IT, Relearning guidance practices*. Daniel has done

Keynotes, workshops, and seminars in over 48 states, Japan, and Canada.

As a consultant, Daniel works with educators, parents and other professionals, helping them to understand the research-based theory and how to adapt curriculum and environments that support the continued development of children and families. Daniel has a unique grasp of children and family issues learned from over 30 plus years of experience working as a teacher, director, educator and parent in both the private and public sector. Daniel's interactive style is both informative and entertaining.

Daniel has received the National Community Education Family Advocate Award, The Catalyst for Change Award, The National Community College Educator Award, Friend to Head Start and continues to be recognized.

Daniel lives in Florida, no longer does he shovel snow or scrape ice. He enjoys the beach, his salt water pool and his Seadoo. He has one daughter Jennifer, who lives in Tokyo, Japan.

Dan enjoys traveling to all parts of the world and meeting new and interesting people.

## Richard Cohen, M.A.

### The Spirit of Play

Friday 8:00am - Room I

Adults get in touch with the kid inside as they joyously play in this unique, powerful workshop.

### Room to Grow

Friday 2:15pm - Room I

Discover how the classroom environment affects children's behavior and learning. The guided imagery exercise in this workshop is a thought and emotion-provoking favorite!



For the last twenty years, Richard has traveled the world as a consultant, coach, and motivational speaker/instructor, facilitating fun, innovative thought provoking, interactive adult learning for communities of early childhood teachers, administrators, caregivers, and parents. Additionally, he curates his viral social media presence, "Zen and the Art of Early Childhood Education," offers online ECE Professional Development courses and hosts Community Sing-a-Longs.

Currently, Richard is the Director of Turtle Island Children's Center, a beautiful indoor/outdoor Nature Preschool that nurtures infants through preschoolers using a "nature-based emergent curriculum" approach, in Montpelier, Vermont.

Prior to his move to Vermont, Richard was a Professor of Early Care and Education at Saint Louis Community College in Ferguson, Missouri for four years. His life was transformed by the shooting of Michael Brown and the ensuing riots that both wrought destruction on and bonded together his community.

# Thursday Workshop Descriptions

## 1 Literacy and Nature- Making the Connection

Cindy Gillett

Children at an early age need to develop a relationship with nature. It is our responsibility to assure that they are connected and become stewards of nature. Let's find creative ways to connect literacy and nature. We will explore, create adventures, help teach respect that will help children enjoy nature through the use of books. **LRN**

## 2 Using Your Outdoor Classroom (repeat)

Nature Explore

Children benefit from using nature as an integral part of daily learning in well-designed outdoor spaces that provide an ideal setting for many learning experiences. This workshop is filled with ideas that spark participants creativity with children while inspiring them to try some of these ideas, adapting them to the age group that they work with. **LRN**

## 3 Nature Based Art in Early Childhood

Stephanie Winkel

Nature can be used to create beautiful process art as well as gorgeous pieces of artwork that the children can admire in the classroom. During this session, you will explore four different art projects/process art activities that utilizes items found in nature. Get ready to use your hands and creativity to explore projects you can do with your early childhood students! **LRN**

## H.E.A.R.T. FAMILY CHILD CARE Helpful Energetic Artistic Responsible Teachers



HEART Family Child Care Support Group offers:

- Monthly meetings at CCR&R in Kimberly which include: Registry approved trainings, opportunities to share curriculum ideas, discussions about concerns related to child care
- Help and encouragement for members to become certified, licensed, or accredited
  - Fundraisers for your family child care
  - Field trips for members

HEART meets monthly, ten times a year, ending the year with a Christmas Dinner.

Trainings for 2019 include:

- Cooking with Children
- PVC Make and Take Ramps
- Fun with Shape Blocks- Make and Take
  - Gardening with Kids
  - Defensive Driving
  - Tour of Centers
- Policy and Parent Communication

For more information on meetings or to join HEART, please contact one of the following HEART officers:

President- Marlene Tiesling at [molly53541@gmail.com](mailto:molly53541@gmail.com)

Secretary- Sarah Fleming at [sfleming2@new.rr.com](mailto:sfleming2@new.rr.com)

# Friday Workshop Descriptions

## Session A 9:30am - 10:45am

### **A1 Celebrating the Active Child**

Dan Hodgins, *Invitations to Learning*

In this engaging workshop we will identify the characteristics of active children and discover ways to support their development.

**DEV**

### **A2 From Playscape to Naturescape: Helping Transform Your Center into a World of Science Discovery**

Andrea Bierbrauer and Luke Shiller, *Heckrodt Wetland Reserve*

This workshop will empower teachers with background knowledge to introduce environmental education into their centers/schools. We will provide workshop participants with three learning objective opportunities that focus on sensory and science, processed-based art, and simple outdoor activities. Participants will have a chance to create correlating make and take activities that follow our three learning objectives. Through this workshop, we hope to make environmental education more exciting and accessible to all centers. **LRN**

### **A5 Using Sign Language with Early Reading Literacy**

Dr. Suzette Garay, *Baby Signs 4 U*

The Northlight Childcare Advantage Program (NCAP) was designed and developed for child care programs wishing to incorporate sign language into their daily routines. Participants will learn new strategies for incorporating sign language

activities within their existing curriculum. You'll leave with an understanding of the benefits of using signing with reading with very young children, and when it is appropriate to teach sign concepts when reading with your children. **INC**

### **A6 Apoyo al Desarrollo de Aprendices de Lenguaje Dual en Programas para la Primera Infancia - Tier 3**

Olga Neira, *WECA - T.E.A.C.H.*

Los niños que aprenden dos idiomas son una población que crece rápidamente en nuestros programas. En consecuencia, aprender cómo responder eficazmente a su desarrollo y a sus necesidades de aprendizaje puede mejorar en gran medida la inclusión social, la adquisición de un segundo idioma (o más) y prepararlos para el éxito escolar. Esta capacitación les ofrece a los participantes una comprensión más profunda de la trayectoria única del desarrollo del lenguaje, en los niños que aprenden dos idiomas, y pone de relieve el papel crucial de la lengua materna para el desarrollo y alfabetización temprana en otro idioma. Juntos, vamos a desarrollar consejos y estrategias para que la enseñanza sea intencional. **DIV**

Dual Language Learners are a fast-growing population in our programs. Consequently, learning to effectively respond to their developmental and learning needs can greatly enhance social inclusion, second language acquisition, and prepare them for school success. This training

gives participants a deeper understanding of the unique language development trajectory of Dual Language Learners, highlights the crucial role of development, and together we will offer tips and strategies for intentional teaching. **DIV Spanish presentation.**

## Session A/B 9:30am - 12:15pm

### **A/B3 Summer/Fall Fingerplays & Songs. Add a Prop & Make them Pop! - Tier 2**

Cindy Gillett

Are your fingerplays in need of some action? We will create props using various materials to enhance the overall experience of singing/learning fingerplays and songs. A visual aid will help keep children's attention and get them involved. Laminating will be offered for an additional fee. **LRN**

### **A/B4 Yoga with Kids - Tier 1**

Stephanie Winkel, *Twinkeling Stars Child Care and Preschool*

Want to teach new gross motor activities as well as teach children self regulation skills? Join us in this session to learn how to incorporate yoga into your child care setting! Stephanie will go through child-friendly yoga poses/moves, resources, and learning tools for teaching children to practice yoga. We will also discuss teaching children how to be mindful and correct breathing techniques when practicing yoga with children. Participants will be asked to try yoga poses out in the session, so please wear socks. Bring a towel or yoga mat if desired, but not required! **LRN**

# Friday Workshop Descriptions

## Session B 11:00am - 12:15pm

### **B1 Roundtable - Room 3101**

Leah Zastoupil, Sarah Fleming  
WFCCA's President and Vice President will be sharing statewide resource information that will help grow your business and ask how the Wisconsin Family Child Care Association can support the child care profession. Please bring all questions, concerns and comments and we will have an open discussion about quality care in Wisconsin. **PRO**

### **B2 Licensing Updates**

Tina Feaster, WI Department of Children and Families  
This workshop will present child care licensing updates. **ADM**

### **B5 Change - It's Not as Hard as You Think for the Food Program or You**

Suzette Warmus, WECA Food Program  
Participants in this workshop will review USDA daily nutrition requirements, explore easy ways to change their meals so they meet new guidelines, and help participants feel empowered by change. **ADM**

### **B6 Lenguaje de Señas - Tier 1**

Dr. Suzette Garay, Baby Signs 4 U  
Gerardo Barrios, traductor  
El Programa Northlight Childcare Advantage (NCAP) fue diseñado y desarrollado para programas de cuidado infantil que deseen incorporar el lenguaje de señas en sus rutinas diarias. Los participantes aprenderán nuevas estrategias para incorporar actividades de lenguaje de señas dentro de su

currículo existente. Se irá con un entendimiento de los beneficios de usar firmar con leer con niños muy pequeños, y cuando sea apropiado enseñar los conceptos de signos cuando lea con sus hijos. **INC** (Repeat of A5)  
**Spanish presentation.**

## Session C 2:15pm - 3:30pm

### **C4 YoungStar Updates 2019/2020 - Tier 1**

Bridget Cullen, Wisconsin DCF & Penny Chase, SFTA  
DCF Staff will be presenting the updates to YoungStar Evaluation Criteria for 2019/2020. DCF staff will be available for questions and answers during the session. **ADM**

### **C5 Be Intentional About Your Professional Development: Use Your Registry as a Guide - Tier 1**

Joshua Vick, The Registry  
This workshop is geared toward the family child care provider who wears many hats. Being a lifelong learner and growing professionally is critical to the child care and education profession. Find out how to utilize your Registry membership to not only track your continuing education, but also guide your professional development. Explore resources such as The Registry Statewide Training Calendar and learn valuable strategies to maximize the benefits of your program profile. Walk away from this workshop inspired to take the next step on your professional pathway. **PRO**

### **C6 Consejos Para Crear un Ambiente Bilingüe**

Xochitl Ortega, X's & O's  
Educational Child Care

Explore un entorno de español donde es fácil de crear en el aula y permitirá a los alumnos adquirir vocabulario y fluidez del idioma con facilidad. **DIV**

Discover how to create an environment that helps children learn Spanish vocabulary and fluency with the language. **DIV**  
**Spanish presentation.**

## Session C/D 2:15pm - 5:00pm

### **C/D1 Making Sense of the Sense: How Limiting Children's Physical Movement Exacerbates Challenging Behaviors - Tier 2**

Abby Abrisham, C. P. Child Care, Inc.

This workshop is designed to find answers to questions of why more children are having trouble with motor skills, attention, and emotional control and what is causing so many young children to require occupational therapy services. Understanding children's responsiveness and our own reaction to the environment can help teachers create classrooms and activities that promote healthy moods. We will discuss the sensory needs of the children, the natural play areas, and ways to design the developmentally appropriate learning environment in which the space and time allows children to play and engage in uninterrupted activities. **GUI.**

### **C/D2 STEAM'N - Tier 2**

Angel Stoddard, UW: Milwaukee  
This idea-provoking session takes STEM (Science, Technology, Engineering, and Math) up a notch! Come find out what the A and the N include. Together we'll take an in-depth look at why

# Friday Workshop Descriptions

S.T.E.A.M'N skills are so important in Early Childhood and how you can use these skills to support early learning and school readiness. Participants will walk away with activities they can use right away, but more importantly they'll also know why these skills are so important in early childhood education. **LRN**

## **C/D3 Changes to the Background Check Policy of the Department of Children and Families**

*Antonio Bouxa, Department of Children and Families*

This workshop is an overview and Q&A of the changes for required background checks for all licensed and certified caregivers in the state of Wisconsin. **ADM**

**Session D 3:45pm - 5:00pm**

## **D4 One Skill at a Time: Practice-Based Coaching - Tier 1**

*Bridget Cullen, Wisconsin*

*DCF & Penny Chase, SFTA*  
Practice-Based Coaching (PBC) is a research-based coaching model that aims to support providers/teachers in the use of high-quality teaching practices leading to positive outcomes for children. The PBC model supports high-quality environments and teacher-child interactions, both of which were added to the 2019 YoungStar criteria. Because of this link, DCF and the YoungStar team are currently working on adding PBC as an additional YoungStar technical assistance option for programs. Come learn more about this model and reflect on your own teaching. **PRO**

## **D5 Creating Child Portfolios using Voice Technology in the Classroom - Tier 1**

*Patricia Wooldridge, Mariposa*

*Learning Center & GrowthChart*  
Participants will learn to use an Alexa/Google Home in the classroom to enhance their curriculum. Additionally, will demonstrate using GrowthChart how to put together or enhance their current child portfolios while keeping WMELS guidance. **OSA**

## **D6 Alfabetización Temprana** *Tammy Pinead Pineda, Madison Public Library*

Aprende a usar música, telas, marionetas y otros accesorios para contar cuentos y para que los niños pueden construir los conceptos de alfabetización temprana que necesitan para tener éxito en la escuela. **LRN**

Learn how to use music, flannel board stories, puppets, and other props to support the development of early literacy concepts children need to be successful in school. **LRN Spanish Presentation.**



Open the box and be ready to...



Hands-On • Research-Based • Materials Included • Authentic Assessment

★ Mother Goose Time ★

Preschool Curriculum

[www.mothergoosetime.com](http://www.mothergoosetime.com) (800) 523-6933



# Saturday Workshop Descriptions

## Session E 9:30am - 10:45am

### E1 A Bunch of Monkeys

Richard Cohen, *Zen and the Art of Early Childhood Education*

Positive strategies for guiding positive behaviors and dealing with negative behaviors. **GUI**

### E2 It's What is Caught not Taught, Prepared Environments of Infants and Toddlers

Michelle Seay *Nurturing*

*Development Infant/Toddler Care*

In this workshop I will discuss the importance of the prepared environment and how much infants and toddlers learn directly from their environments. Including but not limited to incorporating literacy and math into their environments. The prepared environment is our first best assistant to teaching. Exploring perspectives of environments and examples of my own program through photographs and videos. **LRN**

### E3 A Quick Look at Childcare Insurance

David Zauwer, Robertson Ryan & Associates

I have been providing insurance to group and in home day care providers for over 15 years. In my class you will learn the basics of insurance, the risks associated with running a day care and how to transfer that risk to the insurance company. I'm learning every day and would like to pass on this knowledge to those who care for our children. **ADM**

### E4 Making the Most of Your Mixed Ages

Sarah Bucio, *Explore More Learning Center*

The best thing about family child

care is the mixed age groupings. It is a unique & special quality only found in a family child care setting; children learn & grow with a variety of ages & developmental stages AND siblings get to stay together. In this workshop I will provide research based facts on the benefits of a mixed age grouping, followed by ways to use the mixed ages & developmental stages to everyone's benefit (including the provider!). **DEV**

## Session E/F 9:30am - 12:15pm

### E/F5 No Small Matter

Corrine Hendrickson, *Corrine's Little Explorers*

No Small Matter is a feature-length documentary film that reveals how our country is raising its youngest citizens, why making the most of this time in their lives is so crucial, and most importantly, what we can do to change the perception of when learning begins. **COM**

## Session F 11:00am - 12:15pm

### F1 A Bunch of Monkeys

Repeat of E1

### F2 Childcare Cooperatives as Social Ecologies of Resilience for Diverse Children

Amy Christianson & Kate MacCrimmon, *UW-Madison and Reach Dane*

This session will highlight a pilot study being proposed to examine how Danish-inspired, daylong, weekly family child care collectives could be developed into a child care worker cooperative model. The design aims to reduce isolation with a mentorship program pairing experienced and new providers and to develop communities of

practice. Resilience is fostered through these communities of practice to address the growing need for trauma-informed care by children experiencing homelessness and/or displacements by promoting cultural pluralism & incorporating reflective intervention strategies tailored to the social-emotional needs of children ages 0-5 years old. **DIV**

### F3 Farm to Family Child Care

Jill Carlson Groendyk, *Community GroundWorks*

Farm to family child care activities like gardening with children, serving local apples at snack time, and reading books about plants and seeds support healthier children and healthier families. Learn how these activities can help you meet the health and learning goals of your program. Partake in hands-on demonstrations that you could try with your kids tomorrow, and leave with resources to help you get started! **LRN**

### F4 Creating a Felt Board and Pieces for YOUR Environment

Laurie Ann Meyer, *Little Miracles*

This is not a make-n-take, but an informational exchange of ideas and examples for felts. In this workshop participants will learn how to create fabulous felts and ways to make boards to display them. Presenter will share various ways to use books and childhood sayings to make felts and have fun using them in your program. If you never used felts or use them daily come to this training to see what's new. **LRN**

### F5 Roundtable - Room 3101

Repeat of B1





Simplifying the management of your  
employees from *hire to retire!*

**TPC**

THE PAYROLL COMPANY

**HCM | STAFFING | HR | 401k**

Let the experts at TPC help you become more organized and efficient  
through our technology, HR services, and retirement solutions.

**[www.payrollcompany.biz](http://www.payrollcompany.biz)**

**Call us for more information!**  
**877-763-5111**



# Certificate of Participation

Awarded to \_\_\_\_\_ for the

2019 W/FCCA Annual Conference

Sessions attended:

# Workshop Schedule

## Thursday, May 2, 2019

	Room G/H	Room C/E
8:00-9:00 am	Registration Open	
9:00 - 12:00 am	1 Literacy & Nature by Cindy Gillett	2 Nature Explore: Using Your Outdoor Classroom
12:00 - 1:00 pm	Lunch and Networking - Room D/F	
1:00 - 4:00 pm	3 Nature Based Art by Stephanie Winkel	4 Nature Explore: Using Your Outdoor Classroom

## Friday, May 3, 2019

	Room C	Room D	Room E	Room F	Room G	Room H
7:00 am-5:00 pm	Registration Open. Shop the Exhibits - Grand Ballroom					
7:00-7:30 am	First Time Attendee Orientation - Registration Area					
7:45-8:00 am	Welcome and Announcements - Room I					
8:00-9:15 am	Opening Keynote - Dan Hodgins: Getting them Outside - Room I					
9:30-10:45 am	A1 Active Child	A2 Playscape	A/B3 Fingerplays (Double Session)	A/B4 Yoga (Double Session)	A5 Sign Language	A6 Aprendices de Lenguaje Dual
11:00-12:15 pm	Open	B2 Licensing			B5 Food Program	B6 Lenguaje de Señas
12:30-2:00 pm	Lunch, Annual Meeting - Grand Ballroom. Shop the Exhibits - Room I					
2:15-3:30 pm	C/D1 Senses (Double Session)	C/D2 STEAM'N (Double Session)	C/D3 Background (Double Session)	C4 YoungStar	C5 Prof Dev	C6 Ambiente Bilingüe
3:45-5:00 pm				D4 Coaching	D5 Portfolios	D6 Alfabetización Temprana
6:30-8:30pm	No Small Matter Event - Room G, H, I					

## Saturday, May 4, 2019

	Room C	Room D	Room E	Room F	Room G
7:00am-3:00 pm	Registration Open. Shop the Exhibits - Grand Ballroom				
7:00 - 7:30 am	First Time Attendee Orientation - Registration Area				
7:45 - 8:00 am	Welcome and Announcements - Room I				
8:00 - 9:15 am	Opening Keynote - Richard Cohen: The Spirit of Play - Room I				
9:30 - 10:45 am	E1 Monkeys	E2 Environments	E3 Insurance	E4 Mixed Ages	E/F5 No Small Matter (Double Session)
11:00 - 12:15 pm	F1 Monkeys	F2 Cooperatives	F3 Farm to FCC	F4 Felt Board	
12:30 - 2:00 pm	Lunch, Provider of the Year Award - Grand Ballroom. Shop the Exhibits - Room I				
2:15 - 3:30 pm	Closing Keynote - Richard Cohen: Room to Grow - Room I				